

Accessible Route

Building 40 Level 2



Thursday 26 September

BUNFIGHT

CLUBS & SOCIETIES
FAIR

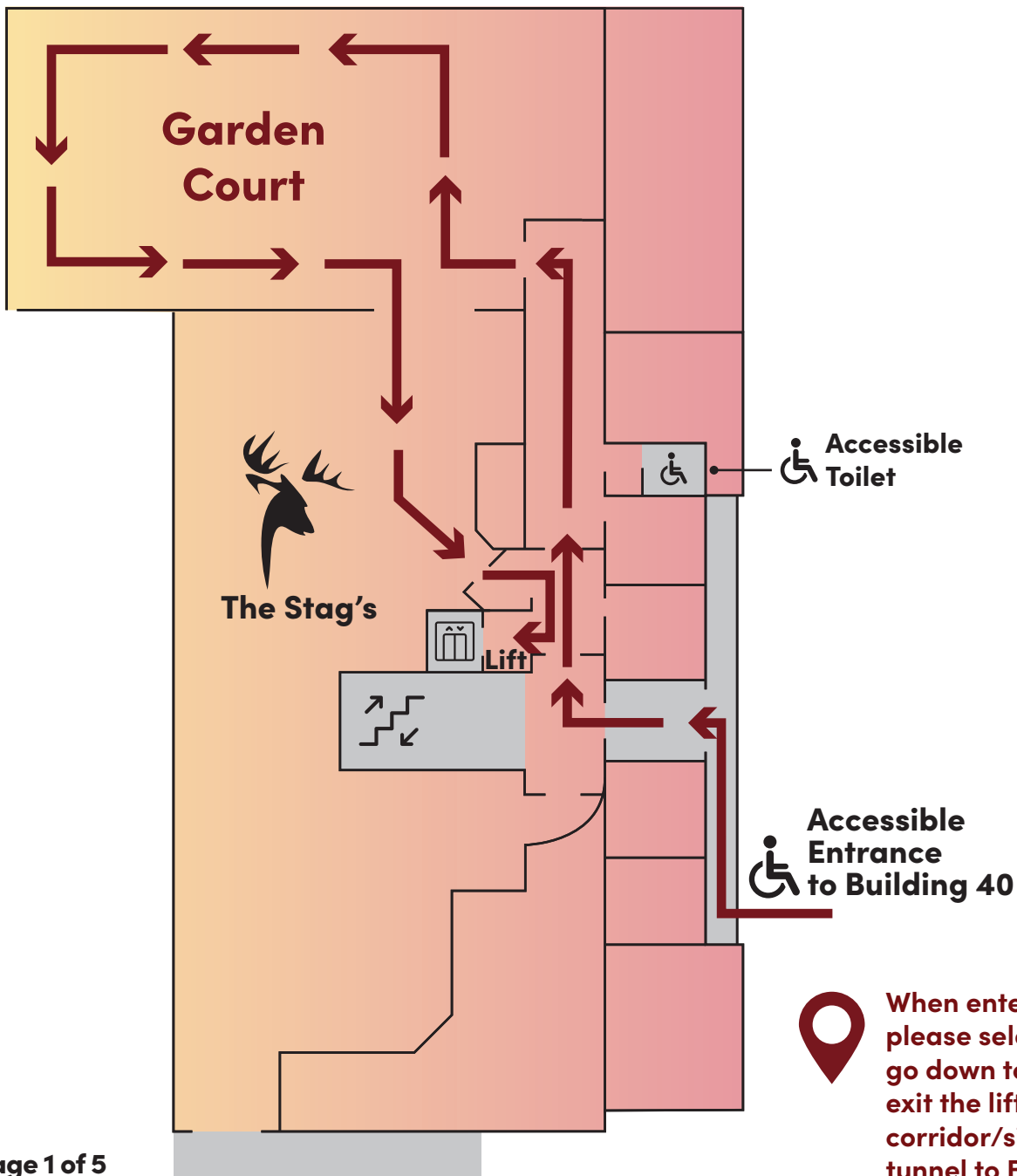

Accessible Route

Building 42 Level 3

Thursday 26 September



**BUN
FIGHT**
CLUBS & SOCIETIES
FAIR

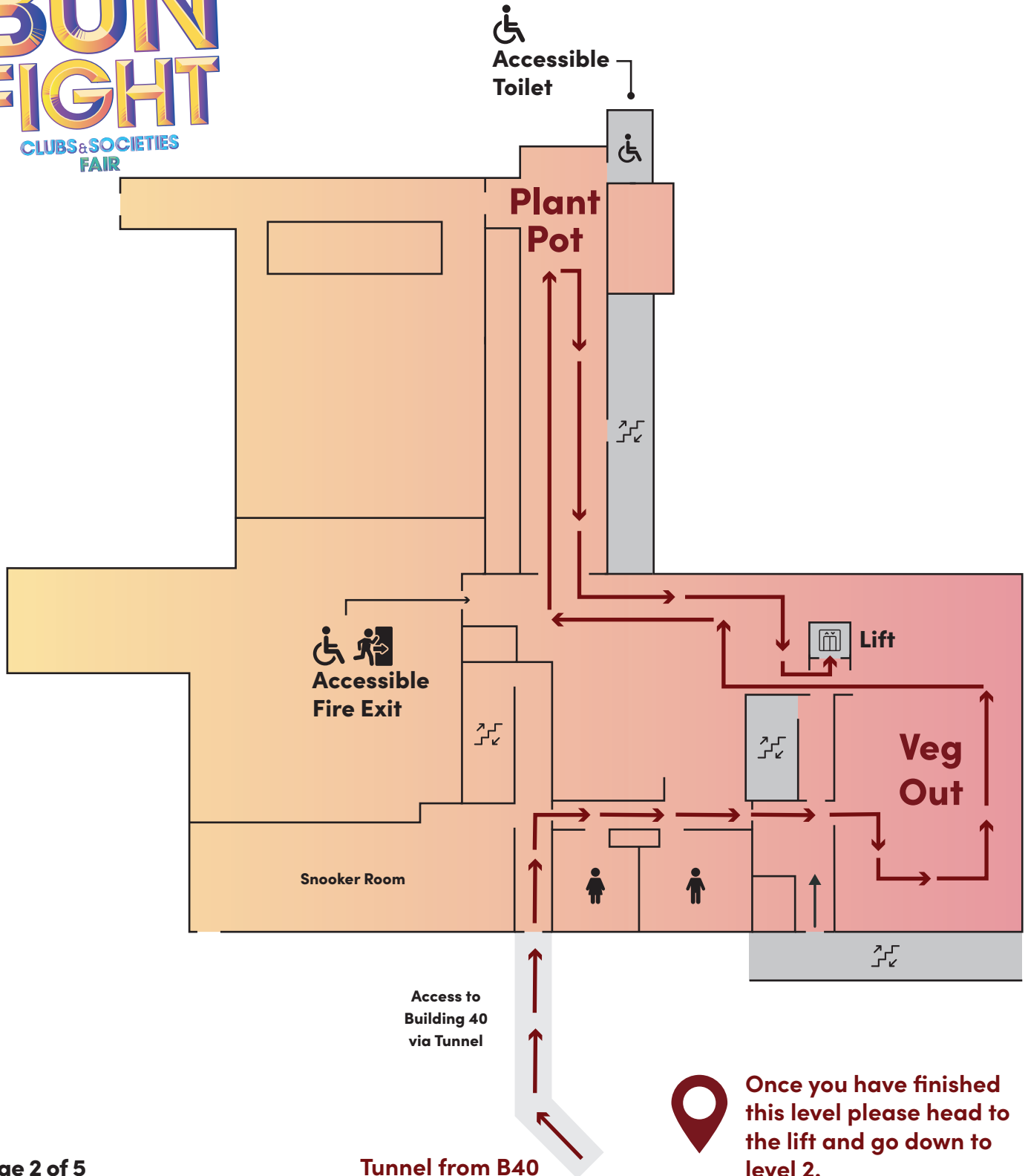

Once you have finished this level please head to the lift and go down to level 2.

Accessible Route

Building 42 Level 2

Thursday 26 September



**BUN
FIGHT**
CLUBS & SOCIETIES
FAIR

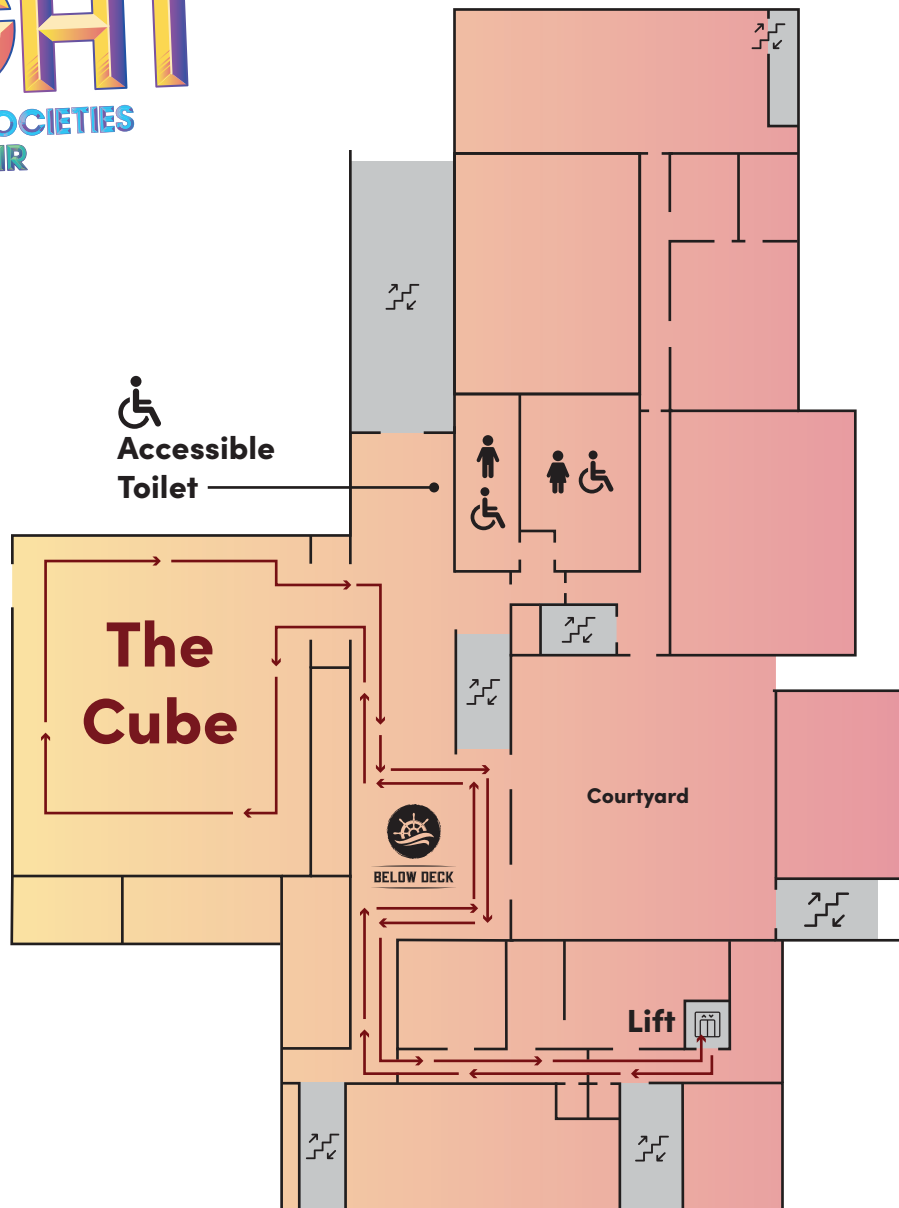

Please take lift
down to level 1
once this floor has
been completed.

Accessible Route

Building 42 Level 1

Thursday 26 September



BUN FIGHT

CLUBS & SOCIETIES
FAIR

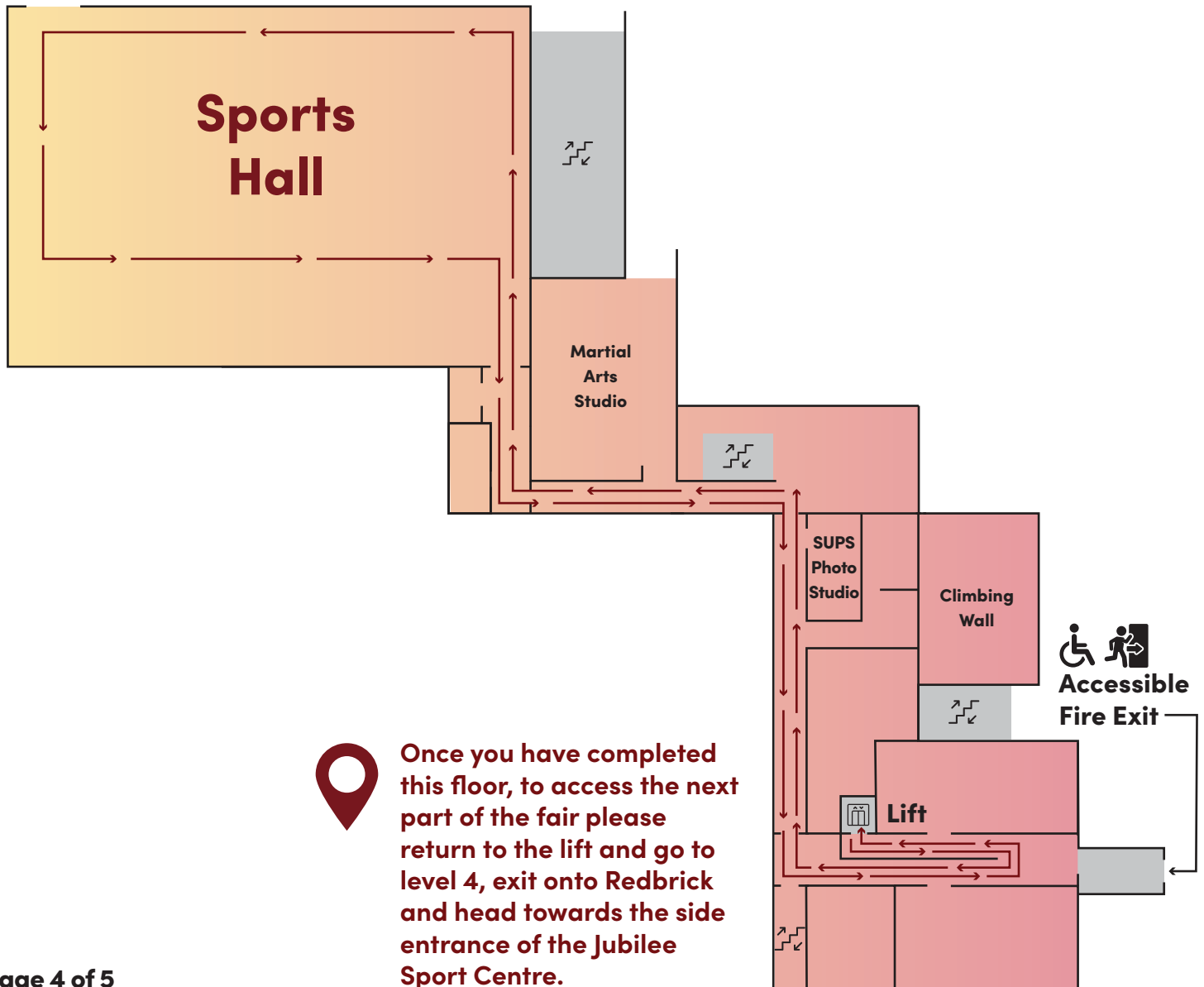

Once you have completed this floor, to access the next part of the fair please return to the lift and go to level 4, exit onto Redbrick and head towards the side entrance of the Jubilee Sport Centre.

Accessible Route

Building 18

Jubilee Sports Centre

Thursday 26 September

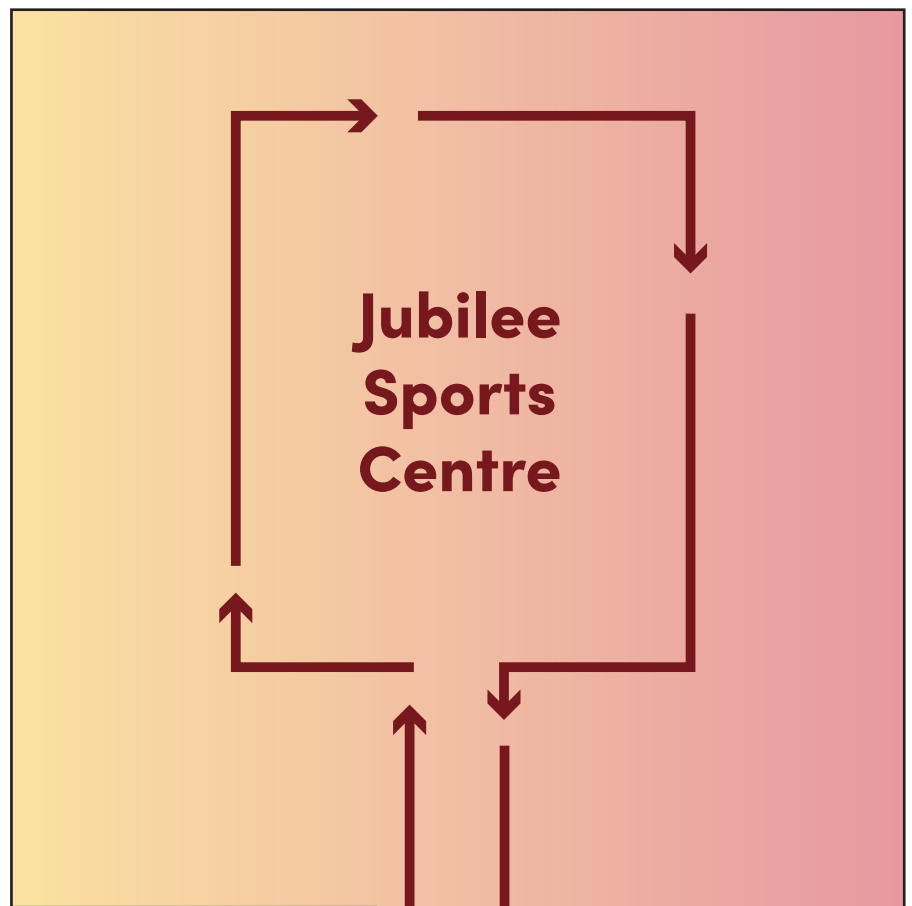

From Redbrick you will need to go down the side of Jubilee to the side entrance to their sports hall. If the incline is too steep please go into the main entrance of Jubilee Sports Centre and use the lift available.